

Beaconsfield Banner

Vol. 1. No. 5.

Published by the Beaconsfield Progress Association

October 1989

PRES. ALBIE JONES Ph. 707 21 41 SEC. TED HORTON Ph. 707 13 13 NEWSLETTER CO-ORDINATOR MYRTLE WILSON Ph. 707 23 04

Council budget – good news & bad

From the President of the Beaconsfield Progress Association, Albie Jones

OUR next public meeting on Wednesday, October 25 at 7.30pm will be the last for this year. It's also the one at which we will elect a new committee for the following 12 months.

If you are a financial member (only \$2 a year) or want to become one, please come along and exercise your vote, or even stand to be on the committee.

The evening will consist mainly of this election plus a cup of tea to follow. So come along, meet your fellow townspeople and have your say.

Our Association has quite good standing with our Shire Council at Pakenham, I believe, and as so much will need to be planned in the near future, it is essential that your views be made known, as we do not want just a few people deciding what ideas for the town will be passed on to Council.

You may even return home as President, as I did, from the first meeting I went to. So come along and try your luck. You don't need to be a Rhodes Scholar.

See you there, Albie Jones.

Growth area meeting

Residents of Beaconsfield and Officer will be given the chance to have their say at a meeting to discuss planning issues on Wednesday, November 8 at 7.30pm in the Beaconsfield Primary School hall.

This is your chance to have some influence on the shaping of future development in the South-Eastern Growth Area (from Berwick to Bunyip).

It will cover key planning questions such as Environment, Transport, Heritage, Community Services, and the placing of new housing areas in this district.

The Ministry for Planning and Environment has four different concepts of the future.

They will be on display until December 15 at the Berwick, Cranbourne and Pakenham municipal offices.

We invite your news and views on any subject pertaining to Beaconsfield and its residents.

Drop your copy in at the School or the Post Office in time for the next edition in mid December, or call one of the Progress Association people whose phone

OVER recent weeks, Council has been meeting regularly to determine expenditure items and the resultant rates for the Council year beginning October 1, 1989.

Budget — what's in it for you?

The bad news is that rates will rise, probably at around 9—9.1/2 per cent.

Items which are to be specifically funded for Beaconsfield and surrounds include:

\$10,000 fund of consultant for Township study

\$5,000 improvements to gravel walking paths

\$30,000 pavement widening, kerb and channeling Beaconsfield Ave (SEC and St Francis Xavier area)

\$1,300 cricket site screens, Beaconsfield Oval

\$10,000 (part) beautification of Princes Hwy and Main Streets (Officer, Beaconsfield and Upper Beaconsfield)

\$10,000 (part) additional playground equipment (Upper Beaconsfield)

\$3,000 Mars Ave — turning circle, etc

\$4,000 Armytage Rd, fire escape road

In addition, we have allocated funds to

A. Intensify the pediculosis (head lice) program

B. Establish a council-community recycling committee

C. Match the government funding to employ a youth worker

D. Construct a new library in Pakenham township.

Beaconsfield Hall

Yes — still the search goes on to find a suitable site. Some new options are now being considered. In

Information courtesy of Cr Peter Meeking

expressions of interest for the land which it owns on the highway, opposite the general store.

Pakenham TAFE

Both Berwick and Pakenham Council have been endeavouring to gain a TAFE College for this district. No firm resolutions or decisions have yet been made, but we are all still hoping.

Dogs

Council's by-laws officers are conducting night time inspections in various towns endeavouring to locate stray dogs.

Every effort is being made to reduce the number of attacks on sheep, etc, by these dogs.

Remember there are automatic and substantial fines for owners whose dogs are found wandering at large.

Recycling

Differing to what may have been suggested, the Council is very carefully considering all options within the area of recycling, and is not intending to take away from the marvellous work already being done by our voluntary groups.

To assist, Council has agreed to a suggestion to form an on-going committee of councillors, officers and community representatives so that a wide range of views can be

Beaconsfield Calendar

Notes from Ted Horton, Secretary,
Beaconsfield Progress Association

Are you or your local organisation trying to organise a special event for next year, 1990?

Well, it has been suggested that the Progress Association publish each couple of months a Calendar of local events in the "Banner" newsletter.

How about it?

I am sure this exercise could well advertise forthcoming events and avoid unnecessary duplication.

Let's hear of that special function and dates by contacting Mrs Mary Perks on 707 4553 or writing a note and putting it in the Post Office 'Banner Article Box'.

Remember, the next edition will be out in December.

Ted Horton

Hair salon

Another business has opened its doors in Beaconsfield. "The Temples" seems an apt name for a hair salon. It is on the ground floor of the Squash Centre in Woods St and has three well-qualified ladies to serve the hair-styling needs of men, women and children. Christine Rogers of Dandenong is Manager ably assisted by Dominique Cavalero of Berwick and Leiza Pugh of Beaconsfield.

Rainfall

As most residents would be aware, rainfall in 1989 has been above average for the nine months to the end of September.

Rainfall recorded in Holm Park Rd totalled 668.6mm. That is 26.32 inches for all you pre metric people.

Figures for the same months over the last five years were:

1985 — 522.4mm

1986 — 538.0mm

1987 — 551.9mm

Did You Know?

1988 — 543.6mm

It is not generally realised that there is significant variation in rainfall in different areas of Melbourne and that Berwick has a higher rainfall than Beaconsfield. For example, for the winter months (June, July, August) this year, Berwick received 337.0mm compared with 295.6mm in Beaconsfield.

In Beaconsfield, the highest rainfall total for one month in recent years was 162.9mm (6.4") for September 1984 (of which 114.3mm fell in six consecutive days).

The highest 24 hour reading during the past five years was 47.5mm recorded at 9am on 26th December 1988 (rain fell mainly on Christmas Day).

Prize Rooster

Mrs Denise Webb is receiving congratulations for her 1st Prize in the Royal Melbourne Show for her New Hampshire rooster. The same bird known as "de Gruchy" also

received a 1st prize at the Berwick Show earlier this year. The big problem is catching, transport and removal from his cage, as like many of his breed he is quite savage.

Make and mingle

A good place to meet people and make friends while you learn craft work is at the Make and Mingle Group run by the Baptist Church on the Princes Hwy.

This happy group meets each Wednesday morning from 10 till 12. A free creche is available for young children.

Change of address

Cr Peter Meeking is now residing at 44 Stoney Creek Rd, Upper Beaconsfield, 3808, and can be contacted as follows:

(059) 44 3568 (private); (03) 836 0761 (message); (03) 705 5237 (business).

SUPA VALU

BEAconsfield



All your grocery
needs
FREE delivery
Ph. 707 1092
'Specials'
advertised in
Monday's Sun
OPEN Sundays
till 1pm

See Alan, Emanuel or Lyn
for friendly service

Letters... Letters... Letters...

Roundabout Call

The Editor,

I'm very concerned about the way cars carelessly, and at fast speeds, come up Stella St and enter Sylvia Rd.

There was a minor head-on collision between two cars at this intersection recently, and I wonder how long it will be before a pedestrian is hurt in this area.

Many children walk by, and some play around this corner. One day a car may hit a child on the footpath.

I would like to see something put on the road, either humps or a roundabout, to avoid accidents happening in the future.

The road is quite wide at the top and could take something on it quite easily.

I will be suggesting this to Council.

Yours etc
Michele Leo.

Congratulations

The Editor,

Congratulations on the very marked improvement with each issue of 'The Banner'. I'm sure all residents must appreciate the variety of news, whether that news is "forward looking" or memories as contributed by Mrs Kath Roberts.

Yours etc

Marie Womersley.

Market Place

This column invites
your two line ads —
price only \$2.

For Sale

1 Pine Cot \$60

1 Safe'n'Sound car seat
\$40

Drop your local news items for
our next issue in to Melva Behr at

Beaconsfield Community Group News

Increasing numbers has forced a move by the Playgroup previously run by the Beaconsfield Community Group in the Infant Welfare Centre.

The limited space and limited time available made the IWC no longer suitable and playgroup sessions are now held in the Old Baptist Church Hall which is situated behind the Baptist Church building, Princes Hwy, Beaconsfield.

Group sessions started at our new location on October 9, our Open Day. They will continue throughout the term and next year on Mondays and Thursdays at 10 am to 11.30 am, except for public holidays and school holidays.

All parents, guardians and care givers are welcome to bring children to either or both sessions each week so they may enjoy the company of other children and mothers in Beaconsfield area. As well the children may experience great fun time activities which can be adventurous, creative or just plain messy fun.

Time to prepare for the fire season

With the summer only a few months away, now is the time to guard against a fire starting on your property.

It's alright to say "It won't happen to me", but what about your next door neighbour?

And we should never forget the horror and trauma of Ash Wednesday only six years ago.

Behind the Central Park Estate and to the north of the town, there is still a lot of bushland up Emerald Rd to Upper Beaconsfield. In the thick undergrowth there is plenty of opportunity for a spot fire which could blow into Beaconsfield. It's up to us to clean up our yards and paddocks to prevent the spread.

Before burning off any rubbish make sure you have cleared the surrounding area and light it so it burns back into the wind, and does not escape from you. Never leave a fire unattended even for a moment in case the wind changes suddenly. If you are burning fire breaks, choose a time when there is very little wind so you can manage it more easily.

If a fire gets out of control, don't hesitate.

Call Beaconsfield Rural Fire Brigade immediately on 707 2828 — a number you should have written down prominently by your telephone. The longer you take, the more danger there is of a major fire getting under way before experi-

Keep in mind that lighting of fires in the town is strictly controlled by the City of Berwick and Shire of Pakenham. Also, no fire may be lit in the open in the summer fire danger period without a permit.

Here are some hints on things you can do to make your place safe from summer fires:

1. Scoop out leaves and hose down gutters; remove dead twigs and leaves from roofs.
2. Do not leave piles of firewood stacked near your house during summer.
3. Dispose of paint tins, boxes, papers, etc before the summer.
4. If you have a large property, put in a fire break around the perimeter. Firebreaks have stopped or slowed a fire, particularly in grassland areas.
5. Ensure you have plenty of water storage near your house and sheds to fight a fire with. (An above ground pool for the kids could be a good investment in this regard.)

Our volunteer firefighters suppress thousands of fires every year.

On Ash Wednesday, there were 180 fires in Victoria. The volunteer fire fighters risk their lives to save yours, so do your best to clean up the hazards around your property and help us to help you.

The group would also like to expand its horizons by starting a toy library so children in the Beaconsfield area may experience and enjoy toys that would otherwise be out of reach for them due to the high cost of good toys these days.

Should a strong interest arise to possibly run a pre-kinder activity session for 3—4 year olds with a teacher, then the group would also like to look into providing such a session.

Members welcome all interested people to come and join in, exchange ideas, enjoy activities with their children, meet new people and if they wish, become more involved in community activities.

The group members will also be taking part in the Shire of Pakenham "Kids Fun Day Extravaganza" to be held on the Pakenham Recreation Reserve. This will be a free day for all kids. Our group will have tunnel fun as well as activities to make and take. Sure to be fun for everyone. Watch our local newspapers for more details.

The Beaconsfield Community Group would also like to take this opportunity to thank some local businesses for their support when approached for donations.

Special thanks to Beaconsfield Timber & Hardware for their kind donation of a gift voucher for goods to the value of \$150 which will be raffled to raise funds for existing and future projects.

H. Kemp



SERVICE &
REPAIRS TO ALL
CARS AND
COMMERCIAL
VEHICLES

**BEACONSFIELD
AUTOMOTIVE
SERVICES**

Michael Perks

Qualified Motor Mechanic

PHONE: 707 4468

Factory 1/94 Princes Highway,

November in your garden

What to do this month?

Annuals can be planted this month but make sure you do not have the soil over rich at the beginning, as this will produce long sappy growth. Before planting, some Osmocote can be put in the bottom of the hole. Suggested plantings could include: alyssum, amarathus, ageratium, antirrhinum, aster, cleome, dianthus, hi-dolly and redskin dahlias, lobelia, marigold, petunia, plox, portulacca, rudbeckia, red and blue slavia, verbena, zinnia. Make sure you mulch around all plantings.

Vegetables can be sown or planted out in well mulched and composted soils. Sow seeds of carrots, parsnips, beans, capsicum, pumpkin, zucchinis.

Chrysanthemums can still be planted. Earlier plantings will need to be nipped back for sturdier plants. Stake tall growers for support.

Roses are beautiful at the moment, but to keep them looking this good make sure you clip off dead flower heads. Keep fertilised, watered and mulched properly.

Fruit trees can be sprayed for codlin moth using carbaryl. Keep the trees fertilised and well mulched.

by Lisa Robinson, Associate Dip. Student, VCAH Burnley

Fertilisers should have a nitrogen content, yet apples and pears need a little extra potash.

Rhododendrons require soil a little on the acid side and plenty of humus or leaf mould in the soil at planting time. Some recommended varieties include: blue tit, eldorado yellow, unique cream to pink, cilipense, racil, bric-a-brac, seta in pink shades.

PLANT OF THE MONTH —

Brown boronia (*boronia megastigma*)

Height and width at maturity — 750 x 750mm. Small evergreen shrubs of semi erect habit. Flowers in spring, solitary brown or yellow bells plus bi-colours. Disease — generally trouble free. Propagation — cuttings. Tolerances: Light — sun, semi-shade. Wind — average. Drought — average to low. Winter — cold to -5°C.

They are not long lived and many fail due to insufficient watering, but their fragrance is wonderful.

Birthwise

Birthwise has been established in the Beaconsfield area after a well attended first meeting on August 30.

Birthwise is a voluntary group supporting women in their birthing choices, wherever they may wish to give birth and whatever their circumstances may be.

The good attendance at the first meeting supports the view that women in the community are not entirely happy with the choices currently available to them.

The group will be offering its members regular informal social meetings, newsletters, support before, during and after birth, information on all aspects of pregnancy and childbirth and birthing, related resources, and a good selection of books, magazines and films on relevant matters for loan.

Elizabeth James, a childbirth educator, will be holding various workshops.

The first, titled 'Birth Helpers', will be on Saturday, November 11 at Pakenham Maternal and Child Health Centre between 9.30 am and 4.00 pm.

It is for women and the people they have chosen to support them during their delivery, whether in a hospital, a birth centre or at home.

More information about this useful day can be gained by ringing Elizabeth on (059) 42 8262.

The next meeting for the group will be held on Wednesday, November 8 at 10.30 am at "Harmony Springs", Fogarty Rd, Tynong North. Once again, everyone is welcome, including children.

Further information about Birthwise or the next meeting can be obtained by ringing Michele Leo on 707 5664.

For all outdoor
needs from tractors,
mowers, chainsaws,
brushcutters,
pumps, etc

Spares, Repairs & Service
Contact Peter Willis

**Beaconsfield Mower
& Tractor Centre**

707 5368

Red Cross plans for counter disaster work

Do you know the Red Cross, including our local members, has a major role in the State Disaster Plan?

As the summer season approaches, the majority of Red Cross units throughout Victoria update the information produced by the Counter Disaster Department at Headquarters.

Our local members are involved in the areas of catering and registration. In the case of bushfires, members would also assist in providing meals for fire brigade personnel as well as evacuees.

Registration of those evacuees is important also to provide information as to areas to which residents have been evacuated.

My message to Beaconsfield residents is that we need our "Friends of Red Cross" to join us and assist in either catering or registration.

A workshop will be held in the Harkaway Hall on Monday, October 30 when catering information will be given from 10am to 11am, and registration discussed from 11am to 12 noon.

In our last article, we appealed for men to become Red Cross minded. Last year, your Progress Association President, Albie Jones, offered to help us in the event of disasters occurring. Why not talk to him?

Bush fires do not constitute the only type of disaster.

Red Cross can be called on when areas have to be evacuated due to tanker collisions, train derailments, floods, searches for lost children or adults, etc. When families are burnt out in house fires, we can also be called on to assist if requested.

If there are any queries and if you would like to offer your valued

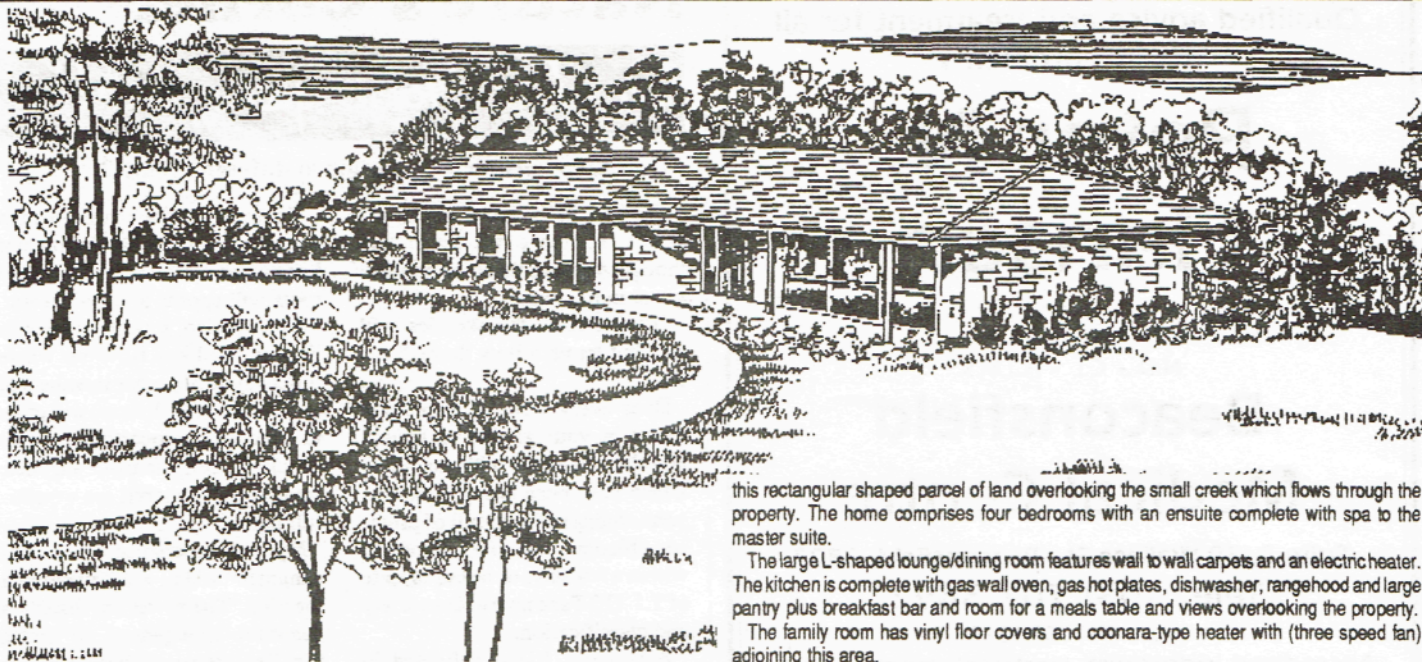
JUDD**REAL ESTATE SCENE**

That elusive five acres

The peace and tranquility of the unique lifestyle offered in Upper Beaconsfield is apparent on entering this property by the circular driveway lined with maturing silver birch trees and looking over the undulating paddocks.

This 4-3/4 acre property offers a rural lifestyle for the hobby farmer or someone just wanting to escape the hustle and bustle of the city. The six year old modern 20 square home sits on

this rectangular shaped parcel of land overlooking the small creek which flows through the property. The home comprises four bedrooms with an ensuite complete with spa to the master suite.

The large L-shaped lounge/dining room features wall to wall carpets and an electric heater. The kitchen is complete with gas wall oven, gas hot plates, dishwasher, rangehood and large pantry plus breakfast bar and room for a meals table and views overlooking the property.

The family room has vinyl floor covers and coonara-type heater with (three speed fan) adjoining this area.

This home also boasts large rumpus/entertaining room with sliding door access to covered timber deck at the rear of the home. From the timber deck one overlooks the above ground pool and numerous sheds including two stables and two day yards for the ponies. A double steel garage is also accessed by separate entrance.

This property is to be Auctioned by JUDD REAL ESTATE of 3 Webb Street, Narre Warren on the 28th October at 2.00 pm.

For further details contact Louise Hammil on 704 8555 or After Hours on (059) 443 018.

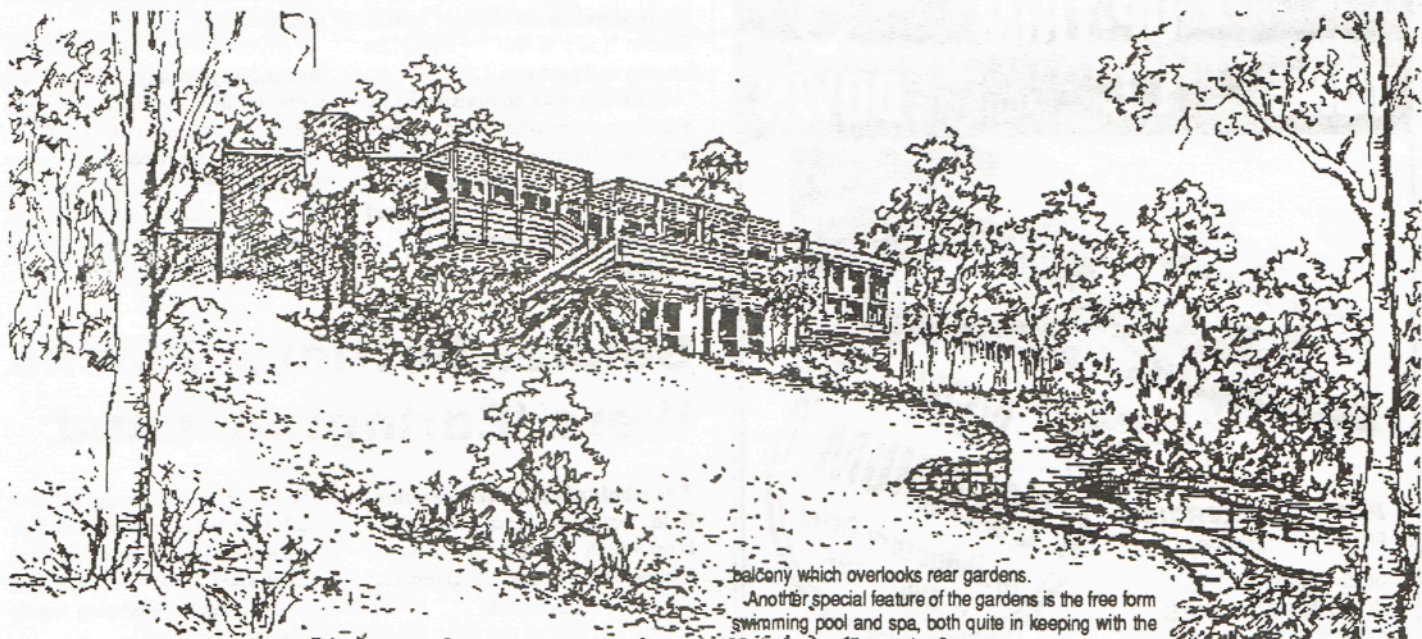

An Upper Beaconsfield original

Typifying the values people place on the environment, peace and seclusion, this striking contemporary residence located on the newly constructed Albers Rd, is to be offered for sale by local agents JUDD REAL ESTATE of Berwick. The home radiates a welcoming warmth from the moment you enter through leafy ferned courtyards to the magnificent elevated rear

balcony which overlooks rear gardens.

Another special feature of the gardens is the free form swimming pool and spa, both quite in keeping with the rustic charm of the native flora.

In terms of accommodation, the property features four bedrooms (master ensuite), formal living rooms and separate downstairs rumpus/games room. Winter warmth is provided via gas ducted heating and a glowing Coonara solid fuel heater provides more intense and cosy heat. Cathedral ceilings, timber lining and expansive glassed areas fill this unusual home with character and charm. We suggest you see for yourself.

Call to arrange a private view on 707 4222, A.H. Elizabeth Gunness (059) 443 440.

JUDD**REAL ESTATE SCENE**

Natural drugless healing ensures
reliable results without side effects
Qualified advice and treatment for all
health problems

Peter N. Hansen

Naturopath
N.D. - C.I. - A.T.M.S.

Beaconsfield Medical Centre

Suite 3, 39 Wallace St., Beaconsfield, 3807

Tele.: (03) 707 3892,

A.H. (03) 707 1214

Accredited iridologist, herbalist, homeopath,
nutritionist, tactile therapist. Also for
manipulation and all emotional problems.

Health fund rebates available

UP-TRIM  **DOWN** 
TONE



PASSIVE EXERCISE

FREE Complimentary
Session (on couches)

OTHER FACILITIES

SOLARIUM - Body Tan

MASSAGE - Relief of aches and stress

FOOT REFLEXOLOGY - Better Health

FACE MASSAGE - The New You



Hints from Mother Nature's Corner

Or 'The Plants strike back!'

How many people are allergic to different plants?

The "wattle" sneezes are an example, yet have we given any thought to plants that may be allergic to individuals?

"Ridiculous", the skeptics will say, but let us follow through the idea.

Does every form of vegetation thrive in your garden or house? Has there been the odd one or two which have been brought into the surroundings robust, full of promising blooms, only to wither or wilt within a few days or weeks in spite of T.L.C.? Take note of the variety and classification.

A personal friend delighted in the fragrance of boronias — boronia megastigma 'chandleri' being a special favorite. She discovered with great disappointment that it refused to grow. One failing specimen was passed over to a neighbour who placed it in a similar position to its former home. Within hours it had regained the beauty and perfume.

Again this was demonstrated by another person who failed to grow any of the 'labiate' family, to which most popular culinary herbs belong — mint, sages, thymes and marjorams, and of course, the lavender.

Yet most people can grow mint from stalks stripped to the top four leaves and placed in water, where roots will appear in a few weeks.

Parsley, also, appears to have its likes and dislikes. However where it does flourish, other members of its family (umbelliferae) will grow to weedlike proportions if not checked. Dill, fennel, angelica, smallage and chervil are wonderful herbs.

My own experience was at Pak-enham Shire Hall when attending a meeting. There was on display a beautiful arrangement of protea mellifera, sturdy, vigorous and in full bloom, until they seemed to sense an alien presence.

They bent over as if in distress and the vase fell over.

Another seat was found and within an hour the re-arranged floral decoration was once more unafflicted.

If anyone else has discovered this insensibility to any plant, please write to this segment, c/- "The Banner", Beaconsfield Post Office.

Scientists are becoming aware that nature holds secrets that man has not yet discovered in spite of all the technical "know-how".

Happy gardening!

Soldier Settlers' Blocks Were 'Edrington' Land

The whole of the South Beaconsfield housing subdivision was land which belonged to Mr A. S. Chirnside of the 'Edrington' property at Berwick.

After the end of the First World War, Mr Thomas Clare Whiteside approached the Chirnside family to see if they would help to establish some returned Beaconsfield servicemen on small farms of their own just across the Cardinia Creek from the railway station.

Between 1918 and 1925 the land was made available and the weather

The road which passed by their south side became known as Soldiers Rd, and the Adamson Rd was named after a returned soldier of the well-known Adamson family in Beaconsfield.

NEXT PROGRESS MEETING

Next meeting of the Beaconsfield Progress Association will be held at 7.30pm, next Wednesday October 25 in the upstairs room of the Beaconsfield Service

Welcome back Melva

Melva Behr, esteemed treasurer of the Beaconsfield Progress Association, returned home last month after seven weeks in Europe with husband Joe.

They had a "lovely time" according to Melva who has promised to write a detailed account for the next edition of the Banner.

"Joe was able to visit places significant in his childhood while I also got to visit the Isle of Skye where my family originally came from."

Melva and Joe first went to England and Scotland before flying to Vienna and touring around Austria staying with Joe's relatives.

"We were warmly welcomed everywhere we went in such a beautiful country.

"Joe was able to visit the home where he spent some of his boyhood in Salzburg with a view from his bedroom window across the river to the castle."

They also toured through Yugoslavia before flying back to Australia.

"It was great to be able to return home and drink fresh water straight from the tap — one thing we dared not do in Europe. There everyone drank bottled mineral water."

We look forward to hearing more about the trip Melva — so start writing!

JOKE CORNER

Some Daffinitions

TANGERINE — A mandarin with sunstroke

CROQUETTE — A romantic lady frog

WOK — Something you frow at a wabbit

BACTERIA — The rear entrance to a cafeteria

COPPER NITRATE — Overtime for a policeman

ICICLE — An evesdropper

BUTTRESS — A female goat

HAVE YOU HEARD THE JOKE ABOUT THE ROOF?

A. It's over your head.

HAVE YOU HEARD THE JOKE ABOUT THE KNIFE?

A. It's a killer.

HAVE YOU HEARD THE JOKE ABOUT THE WALL?

A. I just can't get over it.

DO YOU KNOW THE RIDDLE ABOUT THE BED?

A. It hasn't been made yet.

BEACONSFIELD GARDEN SUPPLIES



For friendly, efficient service

- Sand, Screenings and Cement
- Pavers and Terra Cotta Agi Pipes
- Redgum Chips and Pine Bark
- Sleepers (old and new)
- Scoria and Rocks
- Handyman Hardware

WE CATER FOR ALL BUILDERS, LANDSCAPERS AND TRADESMEN

- Deliveries 7 days a week -

"Call in and say Hello"

94—100 Princes Highway, Beaconsfield

Telephone (03) 707 5144

Beaconsfield Meat Supply

Sell Only Top Quality Meat
"And that's no bull"

Spit hire 707 1163

Roaming Roast Spit Roast Catering -

For your next party or function,
 call the Roaming Roast and let us be your host

Ph. 707 1163

**Whether you're building a
house, a patio, a garden shed,
or even a grand piano...**

For Friendly
and
Personal
Service



**BEACONSFIELD TIMBER
AND**

HARDWARE Pty Ltd

Lot 2 BEACONSFIELD AVE, BEACONSFIELD

707 5055 (5 LINES)

OBHW, PINE, OREGON, K.D MOULDINGS
A/C SHEET, REDGUM, FENCING MATERIAL
FIBREGLASS SHEETING, TREATED PINE
FLOORING, HARDI PLANK

**WE CAN ALSO PROVIDE A LARGE
RANGE OF HARDWARE FOR THE
HANDYMAN AND PROFESSIONAL**

PLEASE CALL IN AND LOOK AROUND